

CN 614

Smooth ball spring plungers

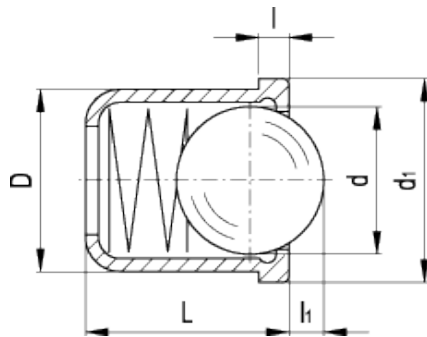

Standard Elements	Main dimensions						Spring pressure		Weight
	Description	D _{+0.1}	L	d	d ₁	l _{±0.1}	l ₁	Preload [N~]	
CN 614-3-KU	3	4	2.4	3.5	0.6	0.6	1.7	3.6	1
CN 614-4-KU	4	5	3	4.6	1	0.8	2.5	6.5	1
CN 614-5-KU	5	6	4	5.6	1	1	4.5	9	1
CN 614-6-KU	6	7	5	6.5	1	1.6	6.5	13	1
CN 614-8-KU	8	9	6.5	8.5	1	1.9	8	18	2
CN 614-10-KU	10	13	8.5	11	1.5	2.4	12	23	3
CN 614-12-KU	12	16	10	13	1.5	3.3	13	25	5
CN 614-4-KD	4	5	3	4.6	1	0.8	2.5	6.5	1
CN 614-5-KD	5	6	4	5.6	1	1	4.5	9	1
CN 614-6-KD	6	7	5	6.5	1	1.6	6.5	13	1
CN 614-8-KD	8	9	6.5	8.5	1	1.9	8	18	2
CN 614-10-KD	10	13	8.5	11	1.5	2.4	12	23	3
CN 614-12-KD	12	16	10	13	1.5	3.3	13	25	5
CN 614-3-MS	3	4	2.4	3.5	0.6	0.6	1.8	3.5	1
CN 614-4-MS	4	5	2.5	4.6	1	0.8	2.5	6	1
CN 614-5-MS	5	6	3.5	5.6	1	1	3	6.5	1
CN 614-6-MS	6	7	4.5	6.5	1	1.6	5.5	11.5	1
CN 614-8-MS	8	9	6	8.5	1	1.9	7	12.5	2



technical informations

Body

- Acetal resin based (POM) technopolymer. Resistant to solvents, oils, greases and other chemical agents (execution KU and KD).
- Brass (execution MS).

Ball and spring

- Execution KU: hardened stainless steel ball, stainless steel spring.
- Execution KD: technopolymer ball, stainless steel spring.
- Execution MS: hardened stainless steel ball, stainless steel spring.

Working temperature

From -30°C to +50°C (for execution KU and KD).

Accessories

Holders for spring plungers type [CN 614.1](#) to optimise the use of CN 614 smooth ball spring plungers.

Application example

CN 614

